

## Optional Accessories

Projection Screens  
Cables & Adaptors  
Security Lock (SEC-LOCK-01)  
Replacement Lamp IN5502/04 (SP-LAMP-055)  
Replacement Lamps IN5532/34 (SP-LAMP-055 and SP-LAMP-056)  
LiteShow II™ Wireless Adapter (INLITESHOW2)  
Ceiling Mount (SP-CEIL-INSTALL)  
Commander Remote (HW-COMMANDER-2)  
Short Throw Fixed Lens (LENS-050)  
Short Throw Zoom Lens (LENS-051)  
Long Throw Zoom Lens (LENS-052)  
Ultra Long Throw Zoom Lens (LENS-053)  
Glossy Black Skin Kit (TOP-05-GB)  
Matte White Skin Kit (TOP-05-MW)  
Walnut Skin Kit (TOP-05-W)  
Primer Skin Kit (TOP-05-B)



## DisplayLink™

Hassle-free, lightning fast-projection. DisplayLink™ Content over USB technology eliminates the need for bulky VGA cables and allows for computer and image set up in seconds without toggling or cumbersome function key combinations. DisplayLink™ makes projecting simple!

## Warranty

Providing the highest quality products and support is very important to InFocus. The IN5500 series of digital projectors come standard with a 5-year limited factory warranty (including parts<sup>1</sup> and labor<sup>2</sup>) a 6 month limited lamp replacement warranty and 5 year DLP® warranty. Extended product and lamp warranty programs are also available. For more information, please visit: [www.infocus.com/support](http://www.infocus.com/support)

## Interchangeable Lenses

Interchangeable lenses provide greater flexibility for a large variety of applications – from short throw to ultra long throw projection.



Navigator - 3 Remote

## IN5500 (SERIES) FEATURES

- 2-3 Pull Down ○
- Auto Keystone ○
- BrilliantColor™ ○
- Cable Management System ○
- Centered Lens ○
- Closed Captioning ○
- Custom Skins ○
- DisplayLink™ Plug & Play (DDC2B) ○
- DMS Dynamic Messaging System ○
- Electrical H&V Keystone Correction ○
- Freeze Frame with Magnifying Function ○
- InFocus UI ○
- LitePort™ USB /JPG Player ○
- LiteShow II™ Wireless Ready ○
- LiteTouch™ Touchsense Keypad ○
- Logo Capture ○
- Low Power Standby (<1W) ○
- Motorized Focus and Zoom ○
- Motorized Lens Shift ○
- Pincushion/Barrel Distortion Correction ○
- ProjectorNet™ Web Browser Control ○
- Sleep Timer ○
- SNMP Capable ○
- SplitScreen™ Dual Images ○
- Top Lamp Access ○

# InFocus

Bright Ideas Made Brilliant

[www.infocus.com](http://www.infocus.com)

**INFOCUS CORPORATE HEADQUARTERS**  
27500 SW Parkway Avenue  
Wilsonville, Oregon 97070-9215, USA  
Phone: (1) 503-685-8888  
Toll Free: (1) 800-294-6400  
Fax: (1) 503-685-8887

**INTERNATIONAL HEADQUARTERS**  
19 Tanglin Road, 7th Floor  
Singapore 247909  
Phone: (65) 6513-9600  
Fax: (65) 6238-0535



©2009 InFocus Corporation. All rights reserved. Specifications are subject to change without further notice. InFocus and InFocus Bright Ideas Made Brilliant are either trademarks or registered trademarks of InFocus Corporation in the United States and other countries. DLP, the DLP logo, and the DLP medallion are trademarks of Texas Instruments. All trademarks are used with permission or are for identification purposes only and are the property of their respective companies.

<sup>1</sup>Excludes power supply, fans, color wheel and light tunnel which are covered for two (2) years.

<sup>2</sup>Labour is covered for two (2) years from date of proof of purchase.

WB\_IN5500\_APAC\_210808. Part Number: MMINFOCUS-0204

# Specifications\*

	IN5502	IN5532	IN5504	IN5534
Native Resolution	IN5502 & IN5532 – WXGA 1280 × 800 IN5504 & IN5534 – WUXGA 1920 × 1200 WUXGA (1920 x 1200)			
Maximum Resolution	IN5502 & IN5532 – DLP® .65" WXGA, DarkChip™ IN5504 & IN5534 – DLP® .67" WUXGA, DarkChip™			
Display Technology - DMD	IN5502 & IN5504 – 5000 ANSI lm, (4,000 lm Eco Mode) IN5532 & IN5534 – 7000 ANSI lm, (5,500 lm Eco Mode)			
Brightness	2500 Hrs Eco Mode (2000 Hrs Normal)			
Lamp Life**	2000:1 Typical			
Contrast Ratio	29 db Eco Mode (30 db High Power)			
Audible Noise	PC, MAC			
Computer Compatibility	Lenses			
Lenses	IN5502 & IN5532		IN5504 & IN5534	
Standard (inc)	Throw Ratio	Zoom Ratio	Throw Ratio	Zoom Ratio
Fixed (LENS-050)	1.52-2.03	1.33x	1.45-1.93	1.33x
Wide Zoom (LENS-051)	0.81		0.77	
Long Zoom (LENS-052)	1.27-1.52	1.2x	1.21-1.45	1.2x
Ultra Long (LENS-053)	2.03-3.85	1.9x	1.93-3.67	1.9x
Motorized	3.85-7.32	1.9x	3.67-6.97	1.9x
Motorized Lens Shift	Motorized			
Pincushion/Barrel Distortion Correction	Lens Shift Type			
ProjectorNet™ Web Browser Control	Lens Shift - Vertical			
Sleep Timer	+10% to -50%			
SNMP Capable	+/- 10%			
SplitScreen™ Dual Images	Colorwheel			
Top Lamp Access	RGBYW / 5 Segment			
	Number of Colors			
	1.07 Billion			
	Aspect Ratio			
	Native 16:10 (4:3, 5:4, 16:9 Supported)			
	Lamp Power			
	IN5502 & IN5504 – 1 ea 330w lamp			
	IN5532 & IN5534 – 2 ea 330w lamp			
	Zoom/Focus			
	Power Zoom, Power Focus			
	Synch - Horizontal Scan Freq			
	15 ~ 100kHz (Video/PC)			
	- Vertical Scan Freq			
	50 ~ 85Hz (Video/PC)			
	Video Compatibility			
	NTSC / PAL / SECAM / PAL-M, N / NTSC4.43			
	SDTV: 480i, 480p, 576i, 576p			
	HDTV: 720p, 1080i, 1080p (60,30,24Hz)			
	Audio			
	5W x 2			
	Input Sources			
	15pin Dsub x 2, 5 BNC, DisplayLink™, LitePort™, HDMI x 2, Component, S-Video, Composite, Stereo Mini x 2, RCA Stereo x 3			
	Output Sources			
	15pin Dsub			
	Stereo-Mini Jack x 1			
	Control			
	2.5mm Stereo Mini, Projector Keypad, IR Remote Control, USB, RS232, RJ45, Wired Remote			
	Screen Trigger			
	3.5mm Mini 12VDC 250ma			
	Network			
	10 BASE-T, 100 BASE-TX			
	Product Weight			
	44.1 lbs / 20.0 kg			
	Product Dimensions - W×D×H			
	17.0 x 26.38 x 9.45 in / 432 x 670 x 240 mm			
	Product Color			
	Matte Black, Glossy Black, Matte White, Walnut, Primer for Customization			
	Shipping Dimension - W×D×H			
	39.0 x 23.4 x 13.0 in / 991 x 594 x 330 mm			
	Shipping Weight			
	57.5 lbs / 26.0 kg			
	Maximum Altitude			
	7,500 ft / 2286 m			
	Remote Control			
	Navigator - 3			
	Ships With - Accessories			
	RGB Cable, Power Cord, USB Mini-G to A, Remote, Safety Instruction, Projector User's Guide, Display Link User's Guide			
	Menu Languages			
	English, French, German, Italian, Korean, Portuguese, Russian, Spanish, Traditional Chinese, Simplified Chinese, Norwegian, Swedish, Finnish, Danish, Dutch, Polish, Turkish			
	Lamp Rupture Containment			
	Tested to larger than 0.8 mm ***			
	Accessories Warranty			
	90 days			
	Regulatory Models			
	F5500 (IN5502, IN5504); F5530 (IN5532, IN5534)			
	Approvals			
	UL60950-1/cUL (USA and Canada), FCC Part 15, Class A (USA), CE (Europe), NOM (Mexico), S-Mark (Argentina), GOST (Russia), KC (Korea)			
	SAFETY Mark (Singapore), CCC, CECP (China), C-Tick (Australia/NZ)			
	Security			
	Kensington Lock			

\* Product specifications, terms, and offerings are subject to change at any time without notice.

\*\* Actual lamp life may vary based on the ambient environment and projector usage. Conditions that may affect lamp life include temperature, altitude, and rapidly switching the projector on and off.

\*\*\* Tested to contain particles larger than the specified size in any dimension

# IN5500 (SERIES)

**InFocus**  
Bright Ideas Made Brilliant

## Simply Stunning

Ease of Use - Sophisticated Features  
Elegant Styling - Stunning Image Quality



# IN5500 (SERIES)

## Outshine the brightest.

Offering best-in-class performance and a wealth of features, the IN5500 series projectors use DLP® DarkChip technology and InFocus award-winning BrilliantColor™ implementation, and offer up to WUXGA (1920 x 1200) resolution. These projectors are ideal for demanding professional applications requiring flexible lens options. With rich connectivity and embedded networking, the IN5500 series also features a filter-free design for fail-safe 24/7 operation. Customizable skins and an integrated cable management give the IN5500 series a sleek, elegant profile to complement any venue. And with a high brightness of up to 7000 lumens, any audience will sit up and take notice.



Optional Skin Glass Black

### IN5502

WXGA (1280 x 800) DLP® DARKCHIP™  
SINGLE 330W LAMP  
Ideal WXGA integration projector.

### IN5532

WXGA (1280 x 800) DLP® DARKCHIP™  
DUAL 330W LAMP, LIQUID COOLED DMD  
For installations requiring fail-safe  
24/7 operations.

### IN5504

WUXGA (1920 x 1200) DLP® DARKCHIP™  
SINGLE 330W LAMP  
HD flexibility at its finest.

### IN5534

WUXGA (1920 x 1200) DLP® DARKCHIP™  
DUAL 330W LAMP, LIQUID COOLED DMD  
Dual lamps and a full range  
of lens options.

### Custom Skins

Choose your cover. With options in Matte Black, Matte White, Glossy Black, Walnut, or pre-primed custom skins, the IN5500 series blends beautifully with any décor.



### Digital, Brilliant Color

The IN5500 series delivers a stunning combination of HD resolution and vivid detail in true-to-life colors with the latest DLP® DarkChip™ technology and InFocus award-winning BrilliantColor™ implementation. For lasting brightness and color that stays.



### High Resolution WXGA/WUXGA

With WXGA (1280 x 800) and WUXGA (1920 x 1200) native resolutions, the IN5500 series offers substantially wider space to display high resolution images for the next generation of operating systems and full high definition 1080p video.



WXGA  
1,280 x 800 PIXELS

WUXGA  
1,920 x 1,200 PIXELS



*We are at the forefront of the Installation Category with best in class performance and the latest in DLP® and Lamp Technology.*

Benjamin Joy  
InFocus Product Director

### Rich Connectivity

The IN5500 series features full analog connectivity with HD15, BNC and component inputs, and HDMI 1.3 for the latest in Computer and HD Video connectivity. Engineered to be Wireless-Ready with LiteShow II™, the IN5500 series also includes embedded networking and RS232 control for full projector management over the network.

### Unique “Blue Iris” Glow Ring

The exclusive InFocus “Blue Iris” glow ring notifies users - from experienced to novice - when the projector is powering up or down. No more guessing what the “beep” or small LED means.

### Single or Dual Lamps

The IN5500 series is available in single lamp for energy efficiency and low cost of ownership, or dual lamps for high brightness and fail-safe back-up protection.

### LiteShow II™

The InFocus LiteShow II™ wireless adapter connects personal computers to InFocus digital projectors wirelessly. The high bandwidth 802.11 b/g connection supports simultaneous transmission of audio along with video/data content, providing a completely wireless multimedia presentation.

### 24/7 Non-Stop Projection

All new InFocus DLP® projectors are filter-free and are rated for 24/7 fail-safe operation, resulting in less maintenance and hours of worry-free use.

### LiteTouch™ Keypad

The sleek backlit LiteTouch™ control panel provides one-touch access to the most commonly used projector functions.

### High Performance Optics

Built-in horizontal and vertical lens shift allows mechanical alignment without optical distortion to retrofit legacy installations. Automatic sensors for ceiling detection and keystone means you will have a crisp, square image everytime. Pincushion and Barrel Distortion is eliminated, enabling the IN5500 series to project perfect images even on imperfect surfaces.

### Projector Management

Control at your fingertips. The IN5500 series built-in web browser allows network administrators to remotely access and control the projector over standard LAN/WAN. The series is compatible with ProjectorNet™ 3.0, our free asset management software that enables you to conserve projector lamp life by scheduling On/Off times, and presetting maintenance events and anti-theft security alerts.

### Dynamic Messaging System

Send dynamic messages for instant display to InFocus projectors using the InFocus Dynamic Messaging System (DMS). Perfect for general and important announcements such as schedule changes, weather warnings, breaking news and emergency notifications.

### Horizontal and Vertical Lens Shift

Motorized lens shift  
- vertical +10% to -50%, horizontal +/-10%

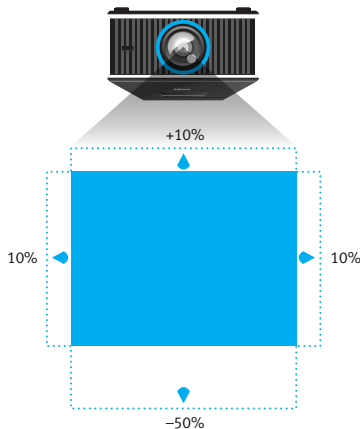

### Intuitive and Easy to Use Interface

Over 20 years of customer feedback has gone into designing the IN5500 series best-in-class menu system. It is easy to navigate, has 17 standard languages and a unique intuitive flow.

### Unique Cable Management System

The integrated cable management system provides easy access to the rich connector panel, while aligning each cable to the cable router. The result: 100% hidden cables that look as good as the rest of your room.

### SplitScreen™

Project images from 2 sources simultaneously and in a variety of configurations with InFocus SplitScreen™ technology. Perfect for viewing multiple presentations, videoconferencing and distance learning.

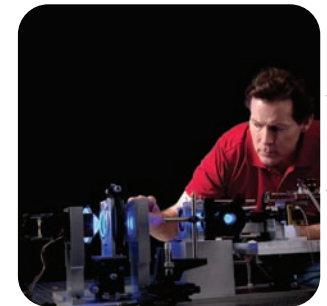
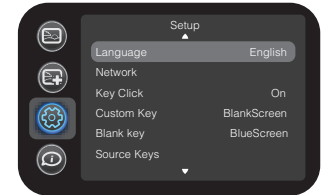

Unique Cable Management System

InFocus Optics Laboratory